

Knauf Gypsum (Thailand)

Company Introduction

Technical Support Thailand

Knauf Gypsum (Thailand)



- **April 2011:** registration
- **Plant :** Hemmaraj Industrial Estate, Saraburi
- **Design & Construction Management :**
 - **Knauf Plant Engineering Team from Germany**
 - **Construction Period : 2012 – 2013**
 - **First Production April 2013**

KNAUF
GYPSUM & ACOUSTIC

- **January 2014 :** Knauf certified with TIS 219-2552 by TISI
 - (TISI Thai Industrial Standard Institute)
- **2015:** Current Staff 130 people
- **2016:** 4th QTR begin Phase 2 construction



Gypsum Production Standards

Comply with known international standards

- **TIS 219-2552** (Thai)
- **AS/NZS 2588** (Australia & New Zealand)
- **ASTM C1396** (USA)
- **EN 520**
 - ✓ **BS 1230** (British)
 - ✓ **DIN 18180** (Germany)



Currently we are undergoing process to acquire

- **ISO 9000** for quality management
- **ISO 14001** for environmental management

Knauf Gypsum Boards

StandardShield

DenseShield

HeatShield

SoundShield

MoistShield

FireBoard

FireShield

Safeboard

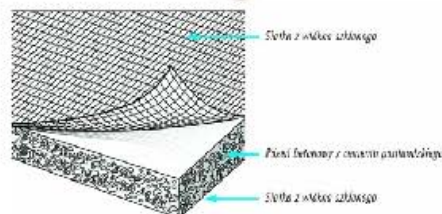

Knauf StandardShield



- German Quality
- Suitable for all Interior partitions & ceilings
- Can be designed to provide Fire Resistant up to 60 minutes
- Thickness (mm) 9, 12, 15* mm
- Typical size (mm) 1200 x 2400 mm

Knauf HeatShield



- Suitable for ceilings directly under the roof or lining on the interior side of the sun facing (south west) walls
- Can be designed to provide Fire Resistant up to 60 minutes
- Thickness (mm) 9 & 12 mm
- Typical size (mm) 1200 x 2400 mm

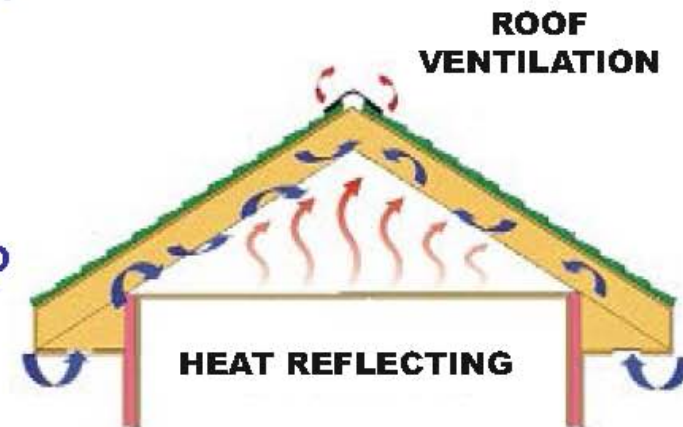

Knauf MoistShield



- Suitable for all Interior partitions & ceilings for the following areas: **Kitchen/ Bath/ Roof Eaves/ Parking Garage/ Resorts & Residential in Coastal Areas (high level of humidity)**
- Can be designed to provide Fire Resistant **up to 60 minutes**
- Thickness (mm) **9, 12 mm**
- Typical size (mm) **1200 x 2400 mm**

Knauf FireShield



- High Core Density with Fiber Glass & Fire Resistant Additives
- Suitable for all Interior partitions & ceilings that require higher level of Fire Safety
- Can be designed to provide Fire Resistant
 - 60, 120, and up to 240 minutes*
- Thickness (mm) 13 & 16 mm
- Typical size (mm) 1200 x 2400 mm



Knauf DenseShield



- **Highest Core Density** with reinforced with Fiber Glass & Fire Resistant Additives
- Suitable for all **Interior public partitions of high traffic areas or premium residential areas that require higher level of**
 1. **Impact Resistant** = to Severe Duty
 2. **Fire Resistant** = to Knauf FireShield
 3. **Sound Resistant** = Knauf SoundShield
- Can be designed to provide Fire Resistant **up to 240 minutes***
- Thickness (mm) **13 & 16 mm**
- Typical size (mm) **1200 x 2400 mm**



Knauf's Brief History 1932 – 2007

In 1932 Alfons and Karl Knauf established a gypsum plaster plant in Perl on the Moselle in Germany, thereby laying the foundation for Knauf, a family owned company.

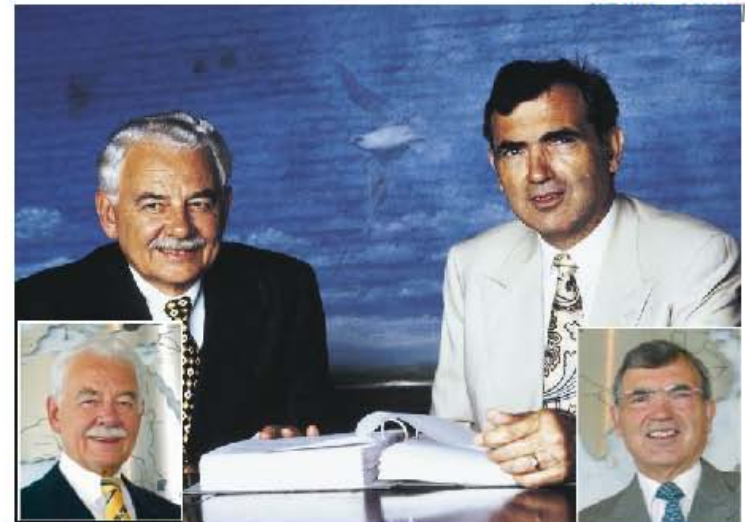

1932



1980 – 2007

Nikolaus and Baldwin Knauf, led the Knauf Group at a healthy growth rate to become a globally successful company for building materials and insulation.

Knauf SoundShield



- High Core Density + Special Board Technology
- Suitable for **partitions & ceilings in areas where higher sound resistant is required:**
 - Office & Meeting Room
 - Classroom & Auditorium
 - Home Theater & Bedroom
- Can be designed to provide Fire Resistant **up to 60 minutes**
- Thickness (mm) **15 mm**

Knauf Fireboard – Encasement System



- Paperless gypsum board
- Engineered to have Higher Resistant to both Moisture & Fire
- Suitable for encasing steel structures and M&E piping or wiring
- Frameless installation*

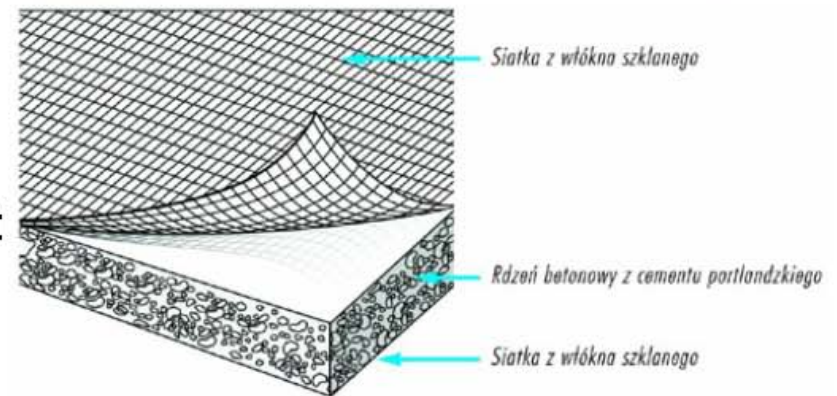

Typical Structural Encasement

Encasement system with frame installation method:
installed using Knauf Clip, C-Lines, & Wall Studs

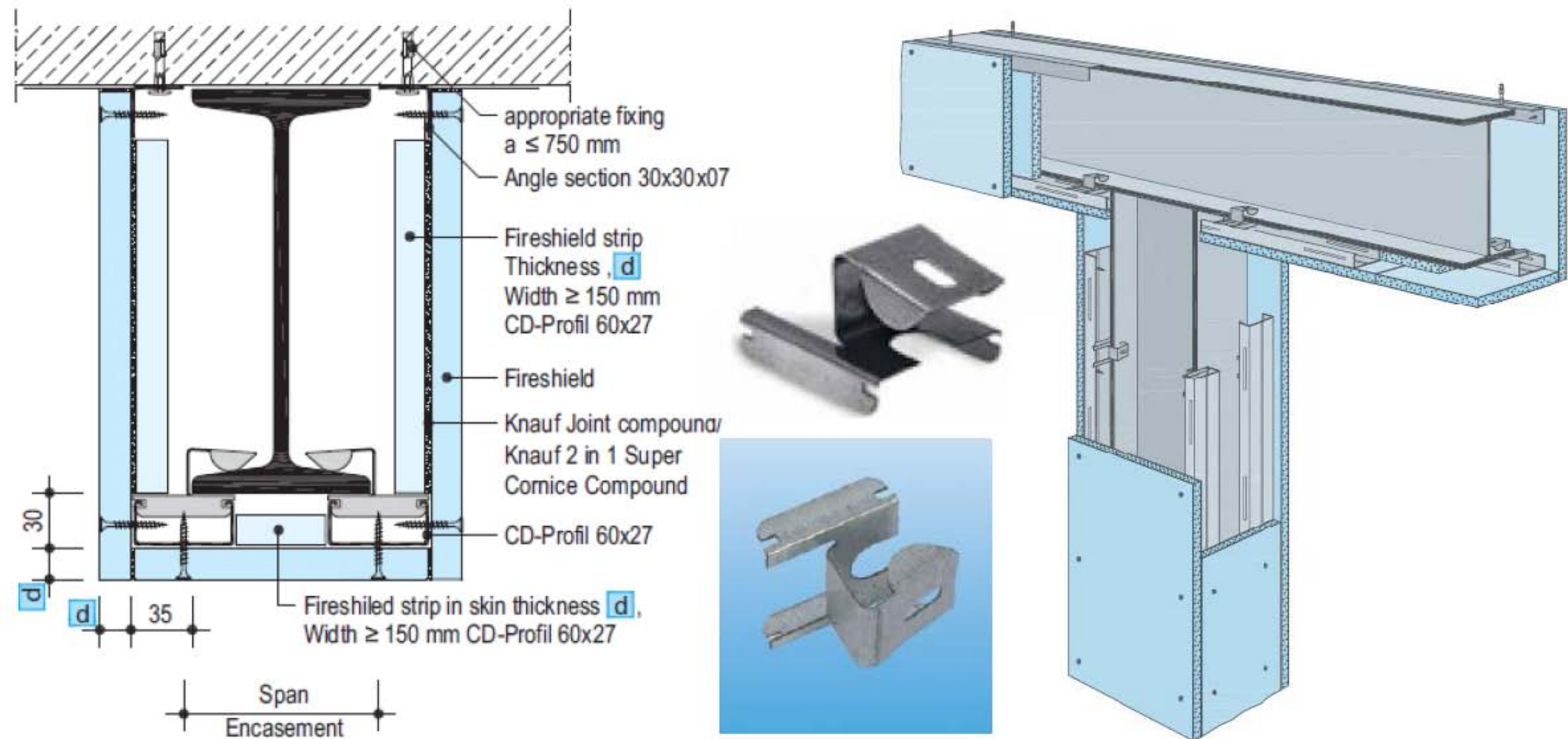

Fireboard

**Frameless Encasement installation method:
installed using only Knauf FireBoard & screws**

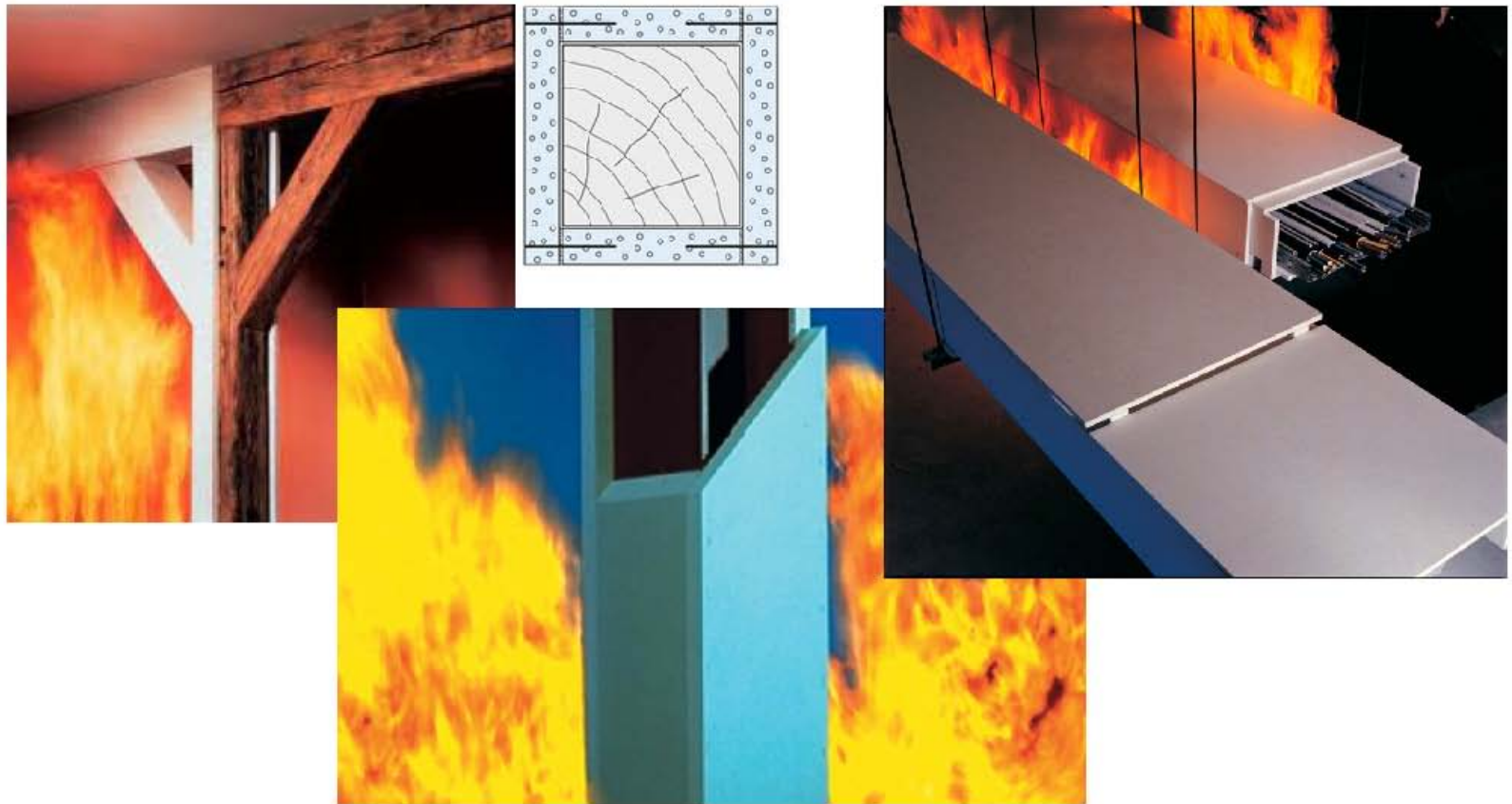

Knauf's Brief History 1949 – a new beginning

In 1949 Knauf relocate from Perl to Iphofen, Northern part of Bavaria in Germany.

1949



Knauf EASE

German's latest "Light Product Technology"
for Gypsum Boards



Knauf's Brief History 2008 – Present



Manfred Grundke and Hans Peter Ingenillem led the Knauf Group from 2008 till 2014.



2008 - 2013

2014 - Present



From 2014 **Alexander Knauf and Manfred Grundke** continue to lead the Knauf Group into the future as personally liable shareholders and General Partners.

The Knauf Group (2015)





Acoustic



Air
Cleaning

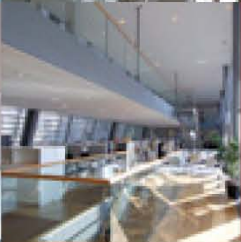
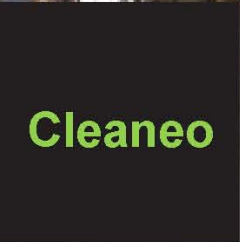

Perforated
Gypsum
Panel



for Ceiling
& Wall
Lining
systems



Danoline

Continuous Perforation Patterns

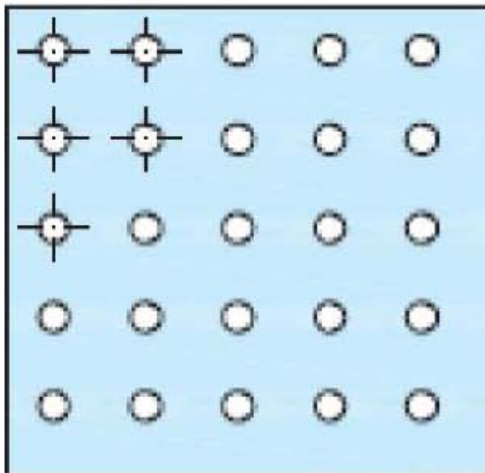

- **Straight perforation round R**

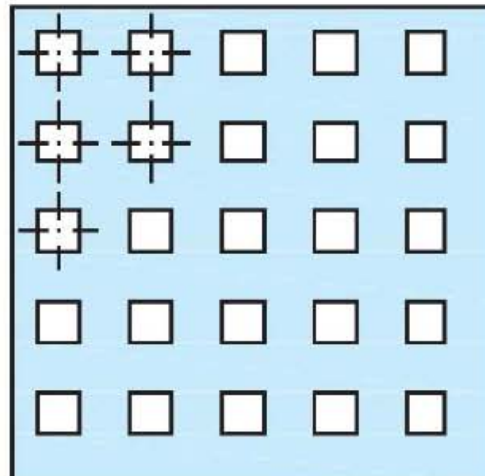

- **Straight perforation square Q**

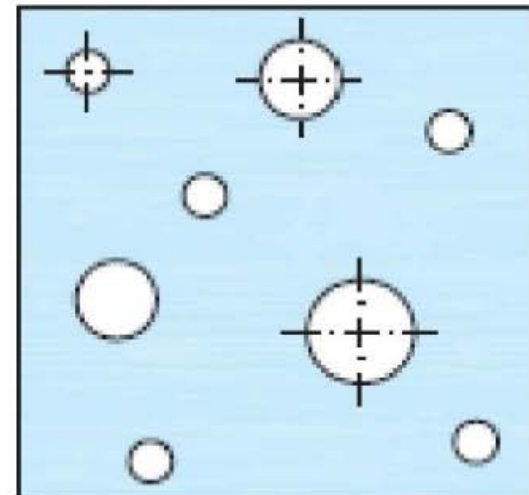

- **Spreaded perforation Plus R**

Fields of Application

Improvement to any room (sound absorption and indoor air quality), e.g. in kindergartens, schools, hotels, residential, offices, and restaurants

- Combined Aesthetic, Acoustic, Air Quality
- Fire Resistance
- Impact Resistance to German's standard for throwing of balls (for gymnasium)

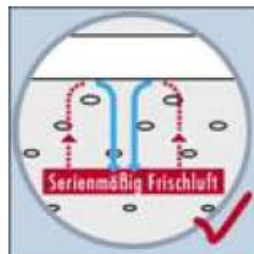

Knauf Cleaneo



Big boards for
a. Concealed Grid Ceiling
b. Wall Lining

Knauf Cleaneo



Knauf Cleaneo

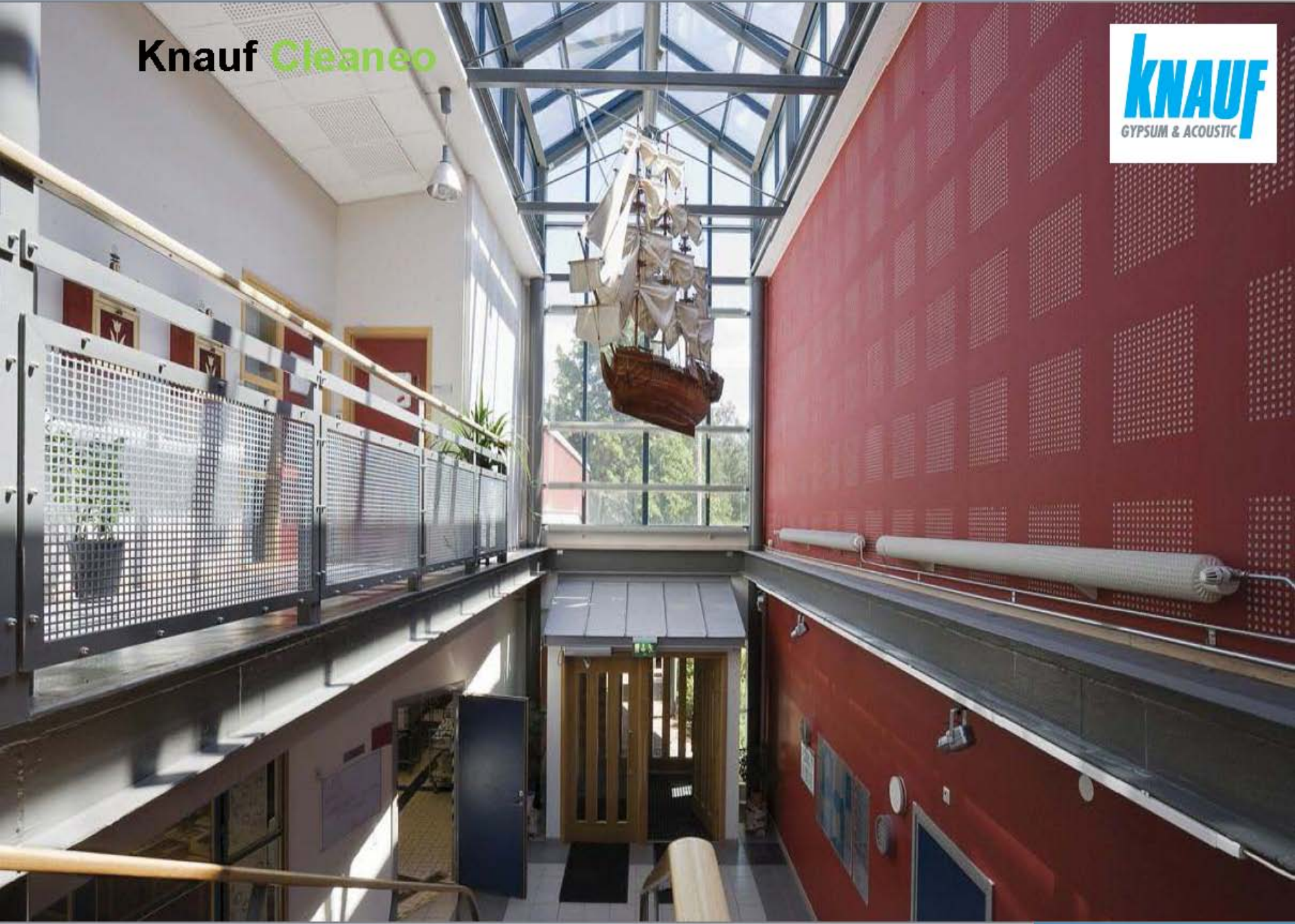

Knauf Cleaneo

KNAUF
GYPSUM & ACOUSTIC



Reference Project: Aeronautical Radio of Thailand

KNAUF
GYPSUM & ACOUSTIC

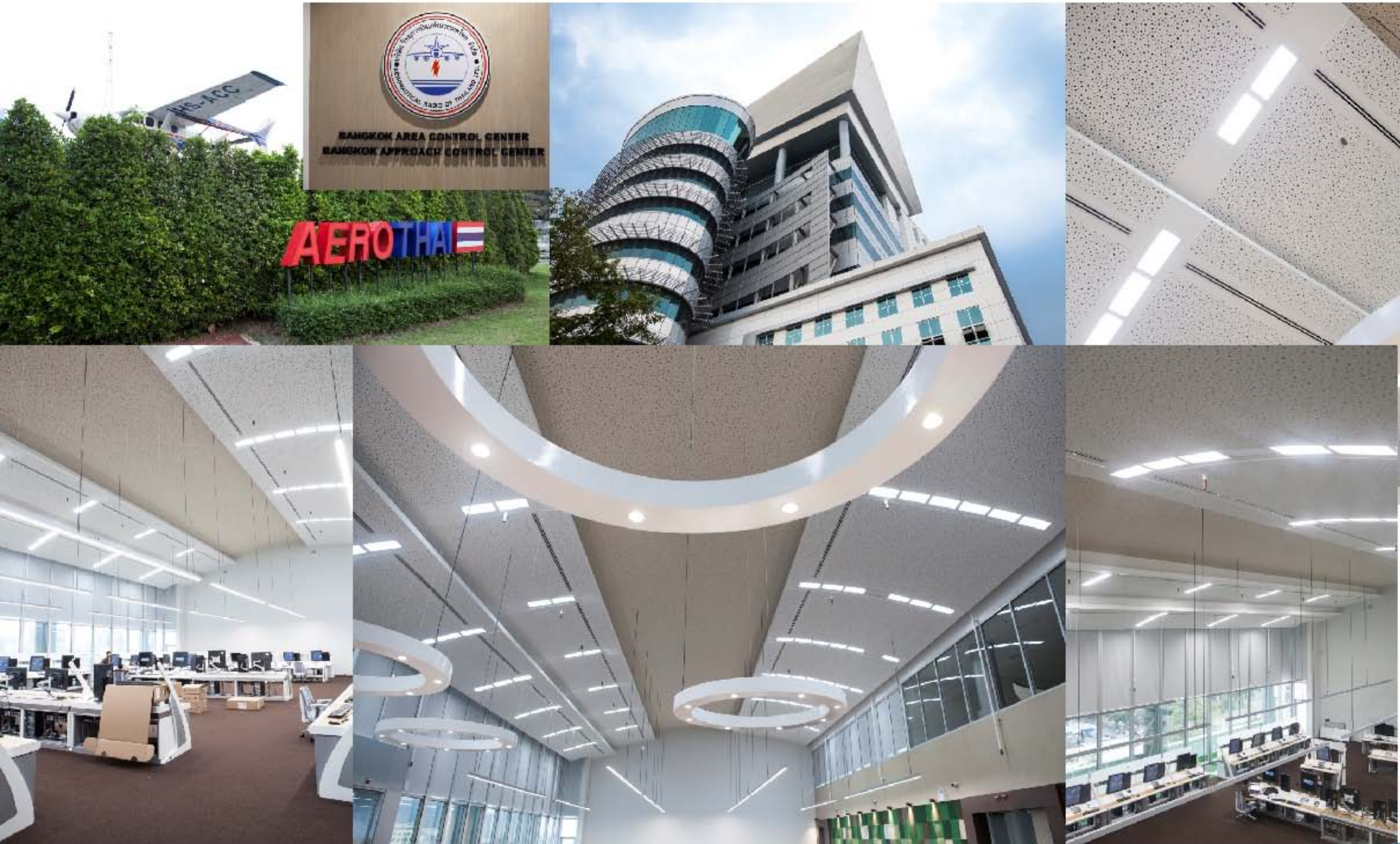

Knauf Danoline



Knauf Danoline

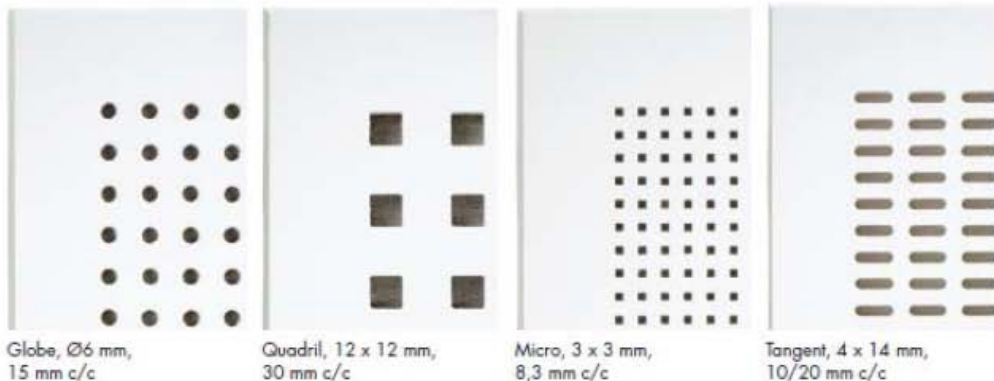

Design Patterns & Sound Absorbing Property.

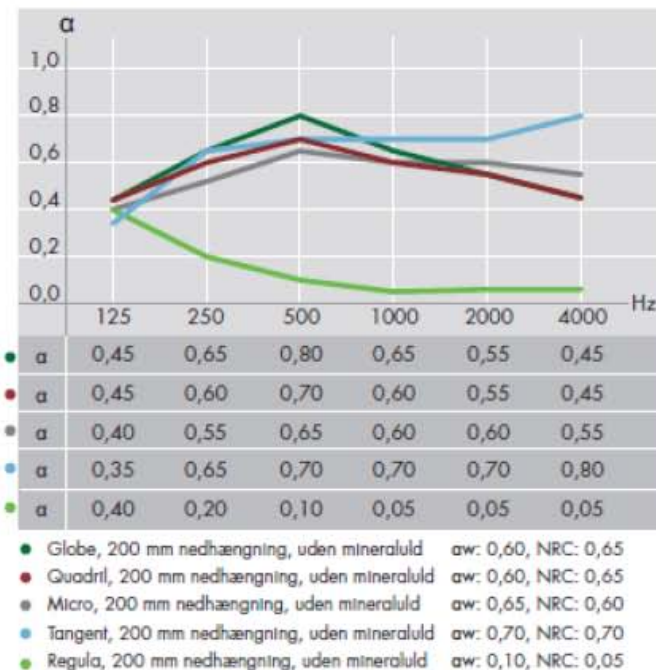

Knauf Danoline

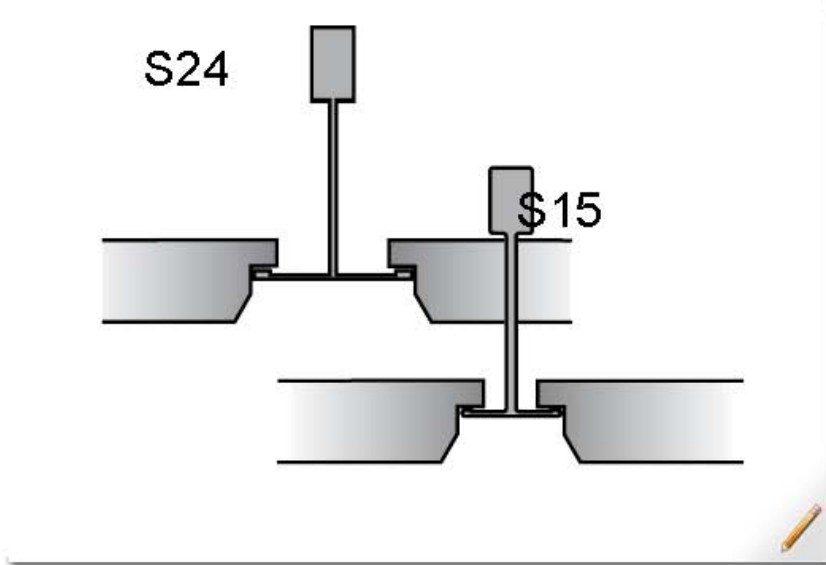

BELGRAVIA

- Recessed grid system
- Painted surface
- Square solution: 600x600
- Rectangular solutions: 300-400 x 600-2400
600/625 x 1200/1250
- Min. installation height: 150 mm (partially 65 mm)

Knauf Danoline



Belgravia



Knauf Danoline

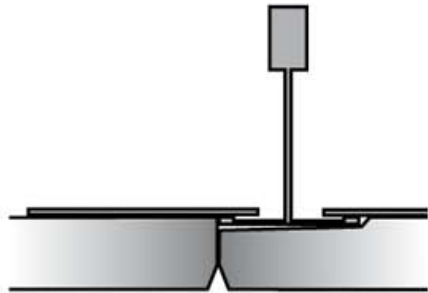

Concealed grid system

Painted surface

Square solution: 600 x 600

Rectangular solutions: 300 x 1200-2400

Min. installation height: 63 mm

CONTUR & UNITY 6 SYSTEM

Knauf Danoline



CONTUR



Knauf Danoline



Knauf Danoline



Knauf Danoline



Knauf Danoline



Thank You for Your Attention



Knauf Head Quarter in Iphofen, Germany



Brief Introduction to Knauf



Arial view of the Headquarter in Iphofen, Germany

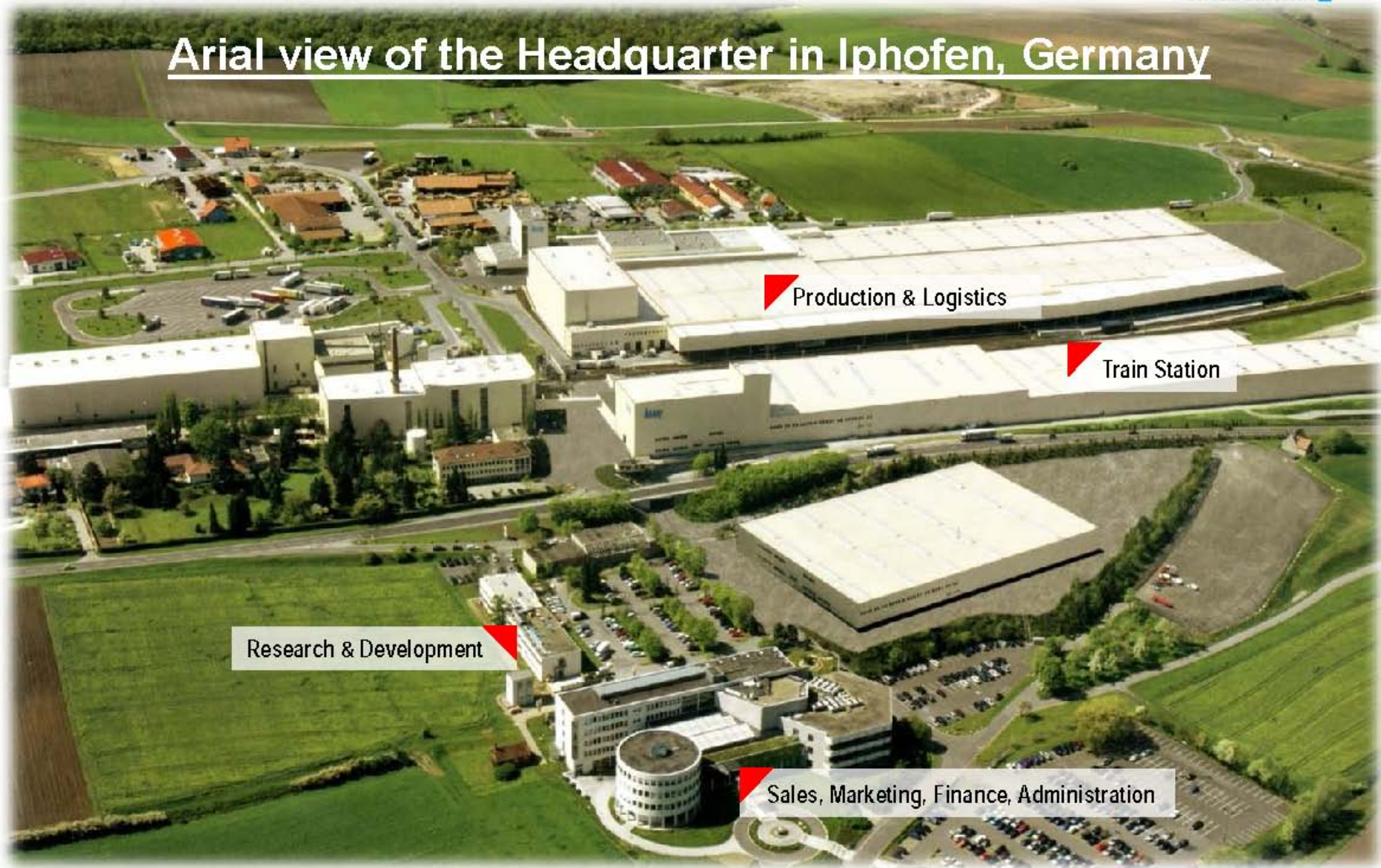

Production & Logistics

Train Station

Research & Development

Sales, Marketing, Finance, Administration